

SINGITA KENNEL

13326 LITTLE TUJUNGA CANYON ROAD
SYLMAR, CA 91342

SANJO INVESTMENTS
5840 Uplander Way, Suite 100
Culver City, CA 90230

FACILITY PHYSICAL DESCRIPTION:

BUILDING AREA (GROSS):
FIRST FLOOR 7,964 S.F.
SECOND FLOOR 3,796 S.F.
TOTAL APPROX: 11,750 S.F.

GROUNDS:
CEMENT / OTHER
TOTAL APPROX: 32,500 S.F.

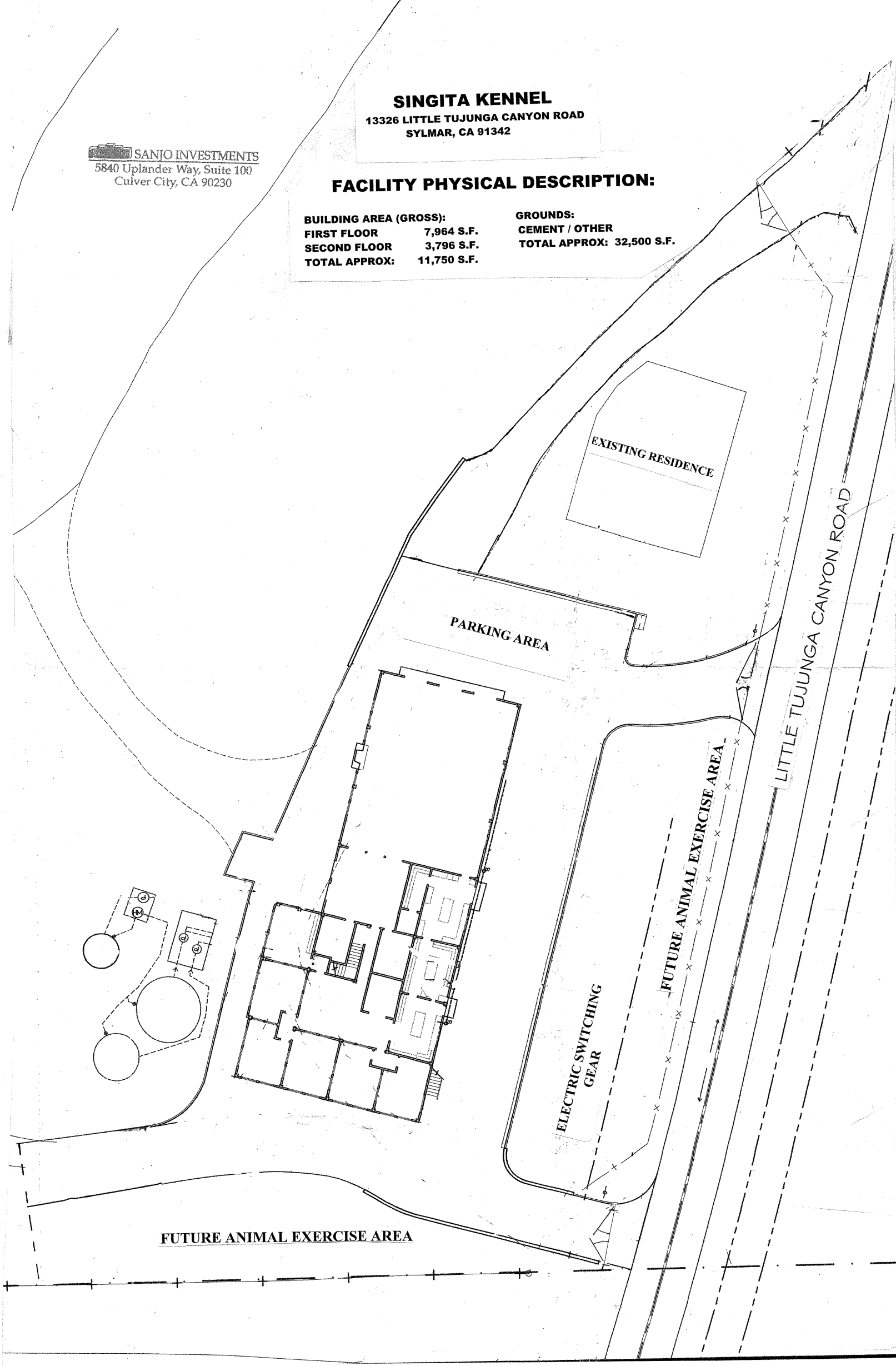

FUTURE ANIMAL EXERCISE AREA